

AKAI

Makes Sense

CAU-7380 CAR RADIO

Short User Manual



MP3 USB/SD/AUX PLAYER

For the detailed user manual please visit the akai-atd.com website. The user manual can be downloaded in PDF format. To read the file a PDF reader application is needed.

Installation

Precautions

Before finally installing the unit, connect the wiring temporarily and make sure it is all connected up properly and the unit and the system work properly.

Use only the parts included with the unit to ensure proper installation. The use of unauthorized parts can cause malfunctions. Consult with your nearest dealer if installation requires the drilling of holes or other modifications of the vehicle.

Avoid installing the unit where it would be subject to high temperature, such as from direct sunlight, or from hot air, from the heater, or where it would be subject to dust, dirt or excessive vibration.

Installing the unit

Front Mount

1. Dashboard
2. Holder

After inserting the holder into the dashboard, select the appropriate tab according to the thickness of the dashboard material and bend them inwards to secure the holder in place. (Fig. 1)

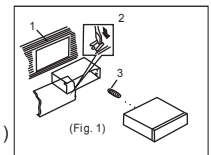

3. Screw

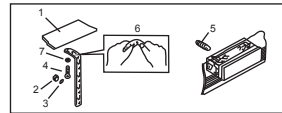

(Fig. 2)

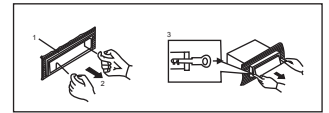

(Fig. 3)

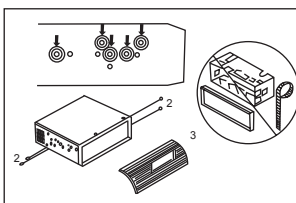

Fastening the unit to the factory radio mounting bracket

1. Select a position where the screw holes of the bracket and the screw holes of the main unit become aligned (are fitted), and tighten the screws at 2 places on each side. Use either truss screws (5 x 5mm) or flush surface screws (4 x 5mm).
2. Screw
3. Dashboard or Console

FRONT PANEL LAYOUT

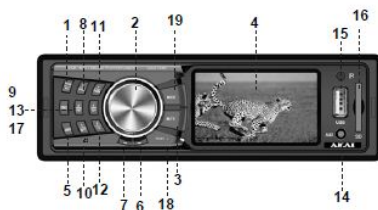

- 1 Power/AV Button
- 2 Volume/Select (VOL/SEL) Button
- 3 Mute Button
- 4 LCD Display
- 5 Automatic Memory Storing
- 6 Tune Seek, Track Forward
- 7 Tune Seek, Track Backward
- 8 Play/Pause Button
- 9 Intro Button
- 10 Repeat Button
- 11 Random Button
- 12 Previous Button -
- 13 Next Button +
- 14 AUX IN
- 15 USB Plug
- 16 SD/MMC slot
- 17 Band Selection
- 18 Reset Button
- 19 Function Selection Button

POWER ON

Under power off status, short press is power on, Under power on status, short press is switching mode, long press is power off.

Sound Adjustment

Press SEL button (2) and choose from the options.

Volume

You can adjust the volume of the device with the VOL(+) and VOL(-) buttons.

Bass

Press VOL/SEL button (2). You can adjust the bass tone here.

Treble

Press VOL/SEL button (2) twice. You can adjust the treble tone here.

Fader

Press SEL button (2) three times. Adjust sound balance between front and rear speakers

EQ On/Off

Select "EQ ON" POP CLASS ROCK EQ OFF

LOUD ON/OFF MODE

In Loud On mode the bass and treble response will be boosted.

Mute

Short press MUTE button to mute the device. Press MUTE button again to turn off the mute function and set back the sound.

Radio Operations

Band Selection

At tuner mode, press BAND button (6) to select the desired band.

Radio Mode

For manual tuning: short press Tune Seek Forward or Tune Seek Backward button in radio mode and tune seeking will start. At a detected channel the seeking will automatically stop. You can store the desired channel by long pressing the number buttons where you would like to store the channel.

More options can be reached on the LCD screen. To know more about these functions please download our detailed user manual from the akai-atd.com website. Here you will find more information about the use of multimedia files.

05

Automatic memory storage

Press AMS(MP3) button (9) for several seconds, the radio searches from the current frequency and checks the signal strength until one cycle search is finished. And then 6 strongest stations are stored into the corresponding preset number button.

USB/SD FLASH MP3 Playing

Press and hold "mode" button to open video/audio files from pendrive. PLAY / PAUSE

Press button (10) pause function is activated. Music track play time INDICATOR flashes.

Press it again to resum eplaying, press it more than 1 second is TOP function.

INT

Press button (11): During INTRO ON, INT indicator comes on and begins. Playing the first 10sec of each song, until the last song is played. It begins playing the entire track from where INT started.

RPT

Press preset button (12): Flash play mode : REPEAT ON / OFF is activated. When REPEAT ON, RPT INDICATOR comes on and repeats the current music track.

RDM

Press preset button (13): During RANDOM ON, RDM INDICATOR is turned on and the tracks of disc is played in random instead of normal order.

SD Card Input

Insert SD card into the slot. After you hear a click sound the card is useable. To remove the card please push the card and it will pop out from the slot. **Important!** You have to format the SD card to FAT32 before use.

06

General Specification

Power Supply	12VDC (12V-15V), negative ground
Maximum Output Power	4 x 50 W
Continuous Power	10W x 4 channel (4 Ω 10% T.H.D.)
Load Impedance	4-8 ohm Ω
Output Voltage	2.0V (playing: 1KHz, 0dB, 10K)
Current Drain	10A
Sound-Noise Rate	60dB

FM Tuner

Frequency Coverage	87.5-108.0MHz (Europe)
Sensitivity	22dB μ
Distortion	< 1%
Frequency Rates	30Hz~15KHz

AM Tuner

Frequency Coverage	522-1620KHz
Sensitivity	25dB μ

Note:

The specifications and other data can change without advanced notification.

Some of the images in this user manual are only illustration.

07

